

Logo of the National Agency for Cadastre and Land Registration (ANCP)	Cadastre and Land Registration Office MURES Cadastre and Land Registration Bureau Targu Mures  <b>LAND REGISTER EXCERPT FOR INFORMATION</b> <i>Land Register No. 136775 Targu Mures</i>	Application no.	<b>98093</b>
		Date	<b>21</b>
		Month	<b>11</b>
		Year	<b>2022</b>

Verification code (barcode)  
100121247955

### A. Part I. Property Description

Urban **LAND**

**Address:** Targu Mures locality, Insulei Street, Mures County

Crt. No.	Cadastral No. Topographical No.	Area* (square meters)	Observations / References
A1	136775	185,272	From CF (Land Register) 129913, 7598 and (A+69) from CF 2403/III Tg. Mures

### B. Part II. Owners and documents

Entries relating to ownership and other real rights		References
<b>17080 / 08/03/2016</b>		
Regulatory act no. 964 dated 05/09/2002 issued by the GOVERNMENT OF ROMANIA (administrative act no. 208/15-02-2016 issued by TIRGU-MURES MUNICIPALITY, cadastral documentation approved by OCPI (Cadastre and Land Registration Bureau) Mures;);		
B1	Tabulation, OWNERSHIP right, acquired by Law, current share 1/1	A1
	1) <b>TIRGU MURES MUNICIPALITY</b> , CIF (Fiscal Identification Code): 4322823, (public domain)	

### C. Part III. BURDENS

Entries relating to divisions of ownership, real rights of guarantees and burdens		References
<b>44468/ 09/07/2020</b>		
Notarial deed no. 894, dated 08/07/2020 issued by Notary Public Onea Gaspar Victor Dumitru; Notarial Deed no. 949, dated 16/07/2020 issued by Notary Public Onea Gaspar Victor Dumitru;		
C1	A right of way for pedestrians and vehicles or equipment is entered in favour of the building registered in CFE 140747 Targu Mures.	A1

## Annex No. 1 to Part I

## Land

Cadastral No.	Area (square meters)*	Observations / References
136775	185,272	From CF (Land Register) 129913, 7598 and (A+69) from CF 2403/III Tg. Mures

\* The area is determined in the Stereo 70 projection plane.

## LINEAR DETAILS OF THE PROPERTY

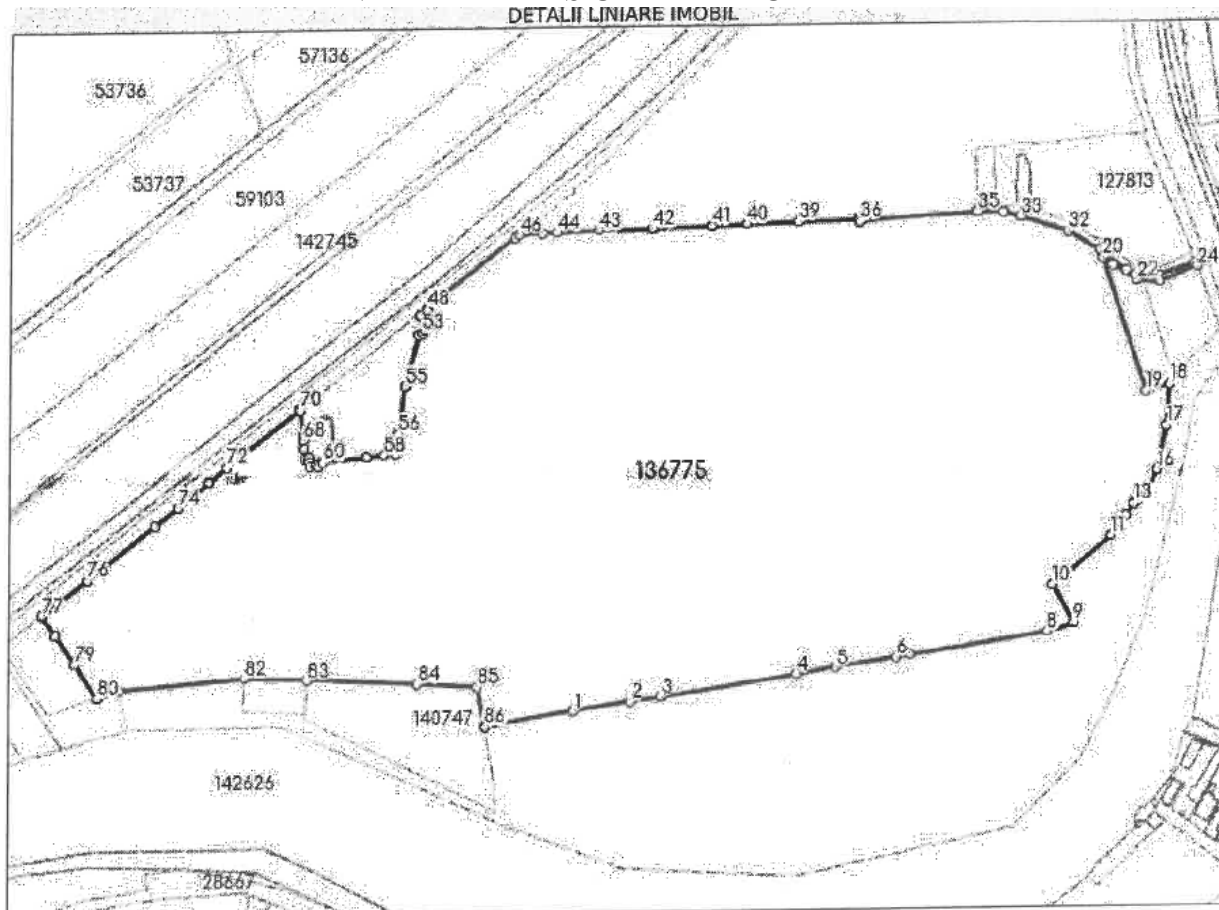

## Data regarding the land

Crt. No.	Category of use	Urban land	Area (m <sup>2</sup> )	Field	Plot	Topographical no.	Observations / References
1	Courtyards constructions	YES	19,306	-	-	-	-
2	Courtyards constructions	YES	165,966	-	-	-	CP - COURTYARDS PARKS

## Length of segments

1) The values of the lengths of the segments are obtained from the projection in the plane.

Start point	End point	Segment length
-------------	-----------	----------------

Punct început	Punct sfârșit	Lungime segment
1	2	40.777
4	5	27.054
7	8	95.894
10	11	53.169
13	14	2.619
16	17	31.284

Punct început	Punct sfârșit	Lungime segment
2	3	21.027
5	6	42.481
8	9	19.474
11	12	17.201
14	15	7.438
17	18	29.002

Punct început	Punct sfârșit	Lungime segment
3	4	95.855
6	7	9.56
9	10	30.002
12	13	10.013
15	16	19.44
18	19	17.167

Start point	End point	Segment length
-------------	-----------	----------------

Punct început	Punct sfârșit	Lungime segment	Punct început	Punct sfârșit	Lungime segment	Punct început	Punct sfârșit	Lungime segment
19	20	97.662	20	21	8.776	21	22	19.923
22	23	16.234	23	24	28.848	24	25	3.167
25	26	26.535	26	27	5.353	27	28	6.861
28	29	3.872	29	30	7.567	30	31	23.797
31	32	26.233	32	33	35.022	33	34	12.349
34	35	18.4	35	36	81.441	36	37	1.764
37	38	0.6	38	39	41.308	39	40	35.603
40	41	24.684	41	42	41.295	42	43	36.451
43	44	28.812	44	45	11.144	45	46	15.986
46	47	3.262	47	48	78.942	48	49	6.694
49	50	4.615	50	51	3.257	51	52	3.057
52	53	2.88	53	54	2.489	54	55	37.136
55	56	32.735	56	57	14.65	57	58	8.196
58	59	12.232	59	60	30.326	60	61	4.151
61	62	1.784	62	63	4.389	63	64	2.169
64	65	3.256	65	66	2.764	66	67	6.677
67	68	5.826	68	69	3.321	69	70	18.097
70	71	0.79	71	72	64.596	72	73	16.353
73	74	28.319	74	75	20.314	75	76	59.513
76	77	40.397	77	78	16.331	78	79	24.511
79	80	28.491	80	81	15.813	81	82	89.468
82	83	44.0	83	84	75.58	84	85	42.31
85	86	28.033	86	1	63.921			

**\*\*The lengths of the segments are determined in the Stereo 70 projection plane and are rounded to 1 millimetre.**

**\*\*\*The distance between the points is made up of cumulative segments that are smaller than the value of 1 millimetre.**

The land register excerpt generated by the integrated IT system of ANCPI (*National Agency for Cadastre and Land Registration*) contains the information from the land register that is active on the date of generation. It is valid under the conditions provided by art. 7 of Law no. 455/2001, in conjunction with art. 3 of the O.U.G. (*Government Emergency Ordinance*) no. 41/2016, exclusively in the electronic environment, for the administrative activities and processes provided by the legislation in force. Its validity can also be extended to the physical form of the document, without a handwritten signature, with the explicit or procedural acceptance of the public institution or entity that requested the submission of this excerpt.

The accuracy and reality of the information contained in the document can be verified at [www.ancpi.ro/verificare](http://www.ancpi.ro/verificare), using the online verification code available in the header. The verification code is valid for 30 calendar days from the document generation moment.

**Date and time of generation,**  
21/11/2022, 10:18

*Illegible signature*

Stamp of VULTUR MARIA ALINA, Public relations officer